



PANEL LEG SERIES,  
SPACE SAVER,  
EXAM TABLES

MODELS: 91100 and 91200  
with ADJUSTABLE BACKREST



ASSEMBLY INSTRUCTIONS

# ASSEMBLY INSTRUCTIONS FOR PANEL LEG SERIES, SPACE SAVER, EXAM TABLES

**MODELS: 91100 and 91200 with ADJUSTABLE BACKREST**

**MAXIMUM WEIGHT CAPACITY 400 LBS**

Thank you for counting on Clinton to meet your medical equipment needs by purchasing this fine equipment. All Clinton equipment is designed and manufactured to provide years of dependable service because we want you as a customer now and in the future. Below are easy to follow instructions on how to properly assemble your equipment. Please contact us at 800-441-9131 if you experience any difficulty with the assembly or have questions.

## INTENDED USE

Clinton Panel Leg Series, Space Saver, Exam Tables, models 91100 and 91200, are specifically designed and engineered for the use by a single person at a time, who is attended to and observed by trained medical personnel. Never leave anyone on the table unattended. Person's weight and the combination of force exerted on the table during treatment is not to exceed a total of 400 lbs.

### 91100



**1**

Place the table's frame upside down on a solid surface that will not mar the upholstery. Place panel leg against the outside of the frame with the circle cutouts facing toward the frame. (**Note: Height of the panel legs are different. Install the shorter leg on the foot end of the table.**) Insert the 2-3/4" pan head bolts through the holes in the leg and frame and secure on the inside of the frame with a flat washer and a KEPS nut. Tighten using a 7/16" wrench and a screw gun. Repeat for the opposite leg.

### 91200



## Hardware

- 2-3/4" Pan Head Bolts....8
- 5/16" Flat Washers.....4
- 1/4" KEPS Nuts.....4
- Barrel Nuts.....4
- 1-1/4" Pan Head Bolts (9013 only).....4

## Tools Required

- Screw Gun
- 7/16" Wrench
- Flat Head Screwdriver

## Time Required

- 20 minutes

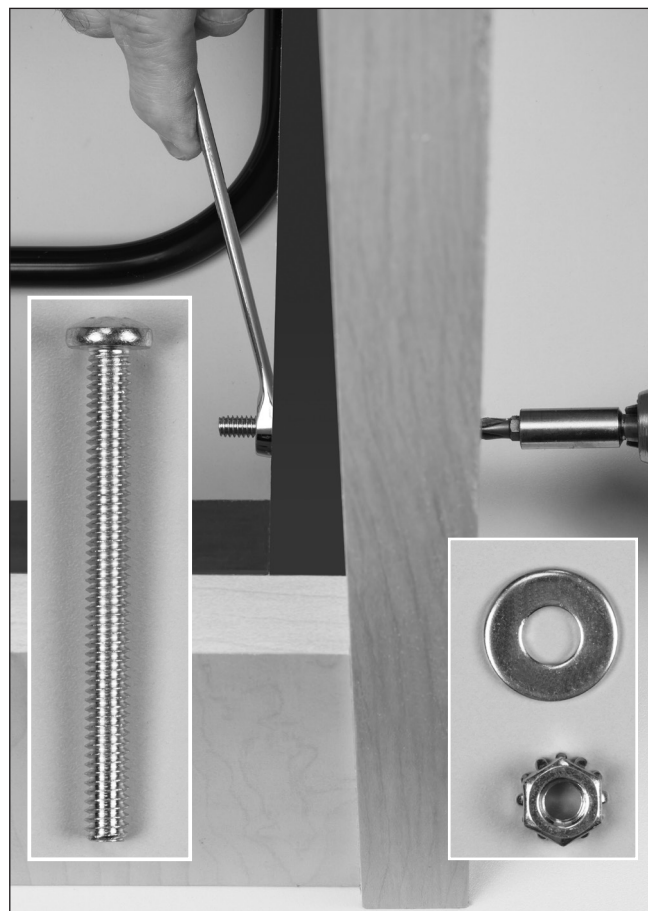

2

Attach the spanner by inserting the flange of the spanners into the notches in the leg.

Next, insert the barrel nuts into the holes in each end of the spanner. Make sure the slot in the barrel nut faces out and is parallel with the spanner. You can turn the nut with a flat head screwdriver to adjust its position. Push the 2-3/4" pan head bolts through the legs and hand tighten into the barrel nuts.

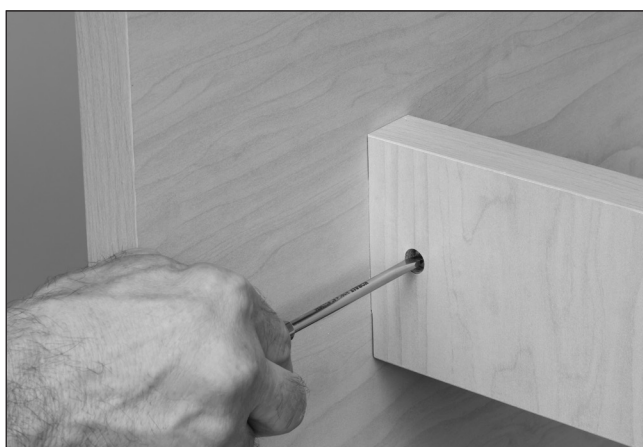
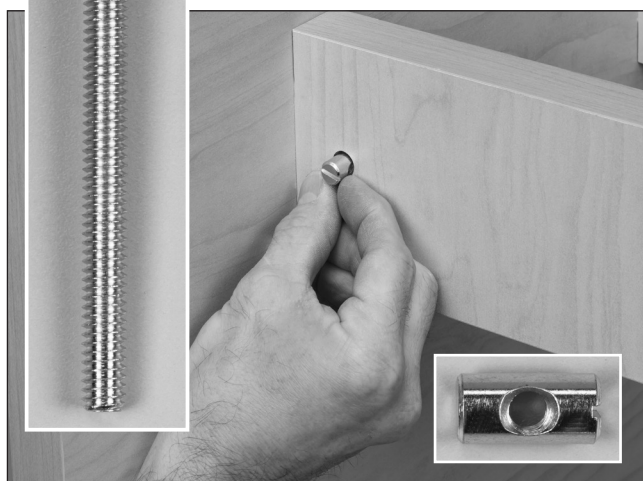
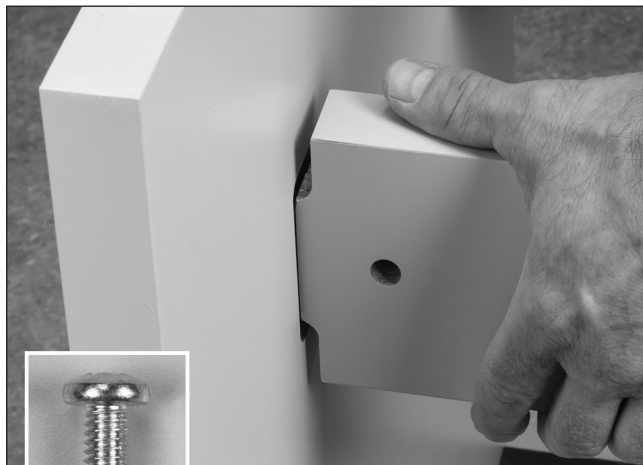

3

Tighten securely with a screw gun.

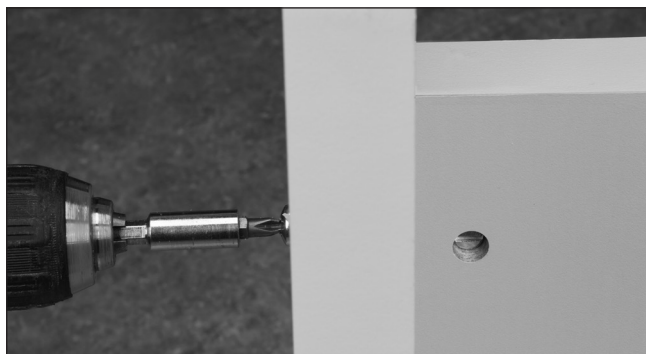

4

#### 91200 HOOK STRIPS

If not attached, place hook strips (included) on each end of the two spanners. Loop strips are pre-attached to the bottom of the shelf.

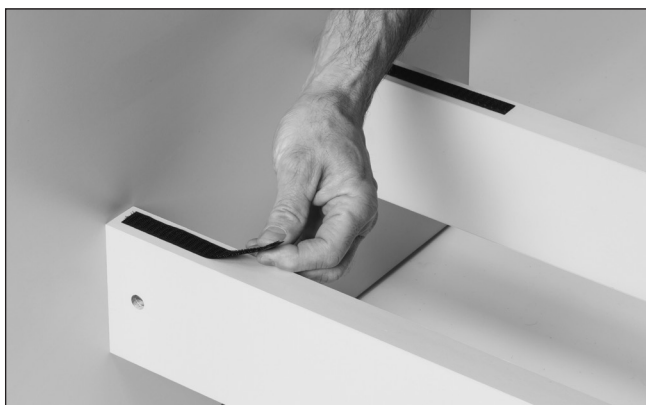

5

#### 91200 SHELF

Position shelf on the two spanners

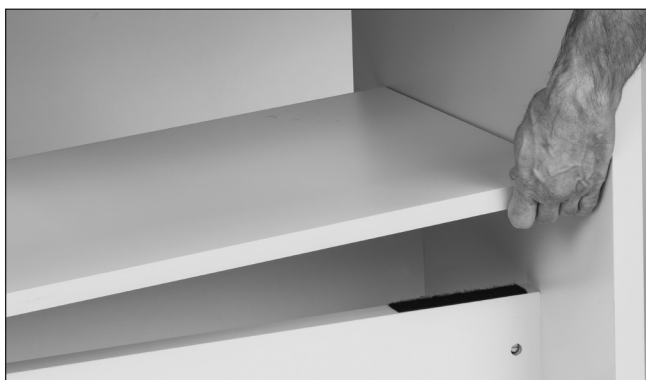

**FOR SAFETY PURPOSES, TAKE TIME TO CHECK ALL SCREWS, BOLTS AND NUTS TO INSURE THAT THEY ARE SECURELY TIGHTENED AND THAT THE TABLE HAS BEEN PROPERLY ASSEMBLED ACCORDING TO THESE INSTRUCTIONS.**

## Warranty

---

Clinton Industries warrants manufactured products to be free of defects in materials, workmanship or design under normal use for five years on all mechanical products and all electrical components from the date of purchase. This warranty does not include damage resulting from accident, abuse or misuse, alteration, or negligence of the product and expressly excludes normal wear of parts (including but not limited to vinyl). Contact Clinton for full warranty details.

**ANY ALTERATIONS TO OUR PRODUCTS VOIDS ALL WARRANTIES AND CLAIMS.**



## Care & Cleaning

---

Clinton products are built to be durable. With proper care, your Clinton equipment will provide years of superior looks and performance. Clean table with a soft cloth and any mild cleaning agent that may be required for sanitation. NEVER use abrasive scrubbing agents that may scratch the surfaces. **Before using any cleaning agents, try them on a small inconspicuous area to insure that they will not harm the upholstery or any other surface.** Damage from cleaning is not covered under the warranty. **Do not use alcohol based cleaning agents.** Periodically check that all fasteners are secure and operating properly.



800-441-9131 • 717-848-3519  
Toll-Free Fax 866-522-1233  
Fax 717-843-5871  
[www.clinton-ind.com](http://www.clinton-ind.com)

